



[DBPR HOME](#) | [ABOUT DBPR](#) | [DBPR DIVISIONS](#) | [CONTACT DBPR](#)

[BCIS Home](#) | [Log In](#) | [User Registration](#) | [Hot Topics](#) | [Submit Surcharge](#) | [Stats & Facts](#) | [Publications](#) | [Contact Us](#) | [BCIS Site Map](#) | [Links](#) | [Search](#)



**Product Approval**  
**USER:** Public User

[Product Approval Menu](#) > [Product or Application Search](#) > [Application List](#) > **Application Detail**

OFFICE OF THE SECRETARY

FL #	FL32359-R2								
Application Type	Revision								
Code Version	2023								
Application Status	Approved								
Comments									
Archived	<input type="checkbox"/>								
Product Manufacturer	Sunshine Windows Manufacturing Inc.								
Address/Phone/Email	1745 West 33rd Place Hialeah, FL 33012 (305) 364-9952 Ext 109 noel_m_2001@yahoo.com								
Authorized Signature	Jalal Farooq veronica@afceng.com								
Technical Representative									
Address/Phone/Email									
Quality Assurance Representative									
Address/Phone/Email									
Category	Exterior Doors								
Subcategory	Sliding Exterior Door Assemblies								
Compliance Method	Evaluation Report from a Florida Registered Architect or a Licensed Florida Professional Engineer <input type="checkbox"/> Evaluation Report - Hardcopy Received								
Florida Engineer or Architect Name who developed the Evaluation Report	Jalal Farooq								
Florida License	PE-81223								
Quality Assurance Entity	Keystone Certifications, Inc.								
Quality Assurance Contract Expiration Date	02/28/2029								
Validated By	Abel Carrasco, PE <input checked="" type="checkbox"/> Validation Checklist - Hardcopy Received								
Certificate of Independence	<a href="#">FL32359 R2 COI SS - Certificate of Independence 2023.pdf</a>								
Referenced Standard and Year (of Standard)	<table border="0"> <thead> <tr> <th><b>Standard</b></th> <th><b>Year</b></th> </tr> </thead> <tbody> <tr> <td>TAS 201</td> <td>1994</td> </tr> <tr> <td>TAS 202</td> <td>1994</td> </tr> <tr> <td>TAS 203</td> <td>1994</td> </tr> </tbody> </table>	<b>Standard</b>	<b>Year</b>	TAS 201	1994	TAS 202	1994	TAS 203	1994
<b>Standard</b>	<b>Year</b>								
TAS 201	1994								
TAS 202	1994								
TAS 203	1994								
Equivalence of Product Standards Certified By									
Sections from the Code									

Product Approval Method

Method 1 Option D

Date Submitted

07/28/2023

Date Validated

07/30/2023

Date Pending FBC Approval

08/02/2023

Date Approved

10/18/2023

**Summary of Products**

FL #	Model, Number or Name	Description
32359.1	Series 1600 Aluminum Sliding Glass Door	Large missile impact resistant aluminum sliding glass door.
<b>Limits of Use</b> <b>Approved for use in HVHZ:</b> Yes <b>Approved for use outside HVHZ:</b> Yes <b>Impact Resistant:</b> Yes <b>Design Pressure:</b> +80/-80 <b>Other:</b> See drawings 20-36F for span vs load combination and installation details.		<b>Installation Instructions</b> <a href="#">FL32359_R2_II_SS - 1600 SGD (LMI) - DWG 20-36F (2023).pdf</a> Verified By: Jalal Farooq PE # 81223 Created by Independent Third Party: Yes <b>Evaluation Reports</b> <a href="#">FL32359_R2_AE_SS - 1600 SGD (LMI) - PAE 2023.pdf</a> Created by Independent Third Party: Yes
32359.2	Series 1600 Aluminum Sliding Glass Door	Non-impact resistant aluminum sliding glass door.
<b>Limits of Use</b> <b>Approved for use in HVHZ:</b> Yes <b>Approved for use outside HVHZ:</b> Yes <b>Impact Resistant:</b> No <b>Design Pressure:</b> +90/-135 <b>Other:</b> See drawings 20-30F for span vs load combination and installation details.		<b>Installation Instructions</b> <a href="#">FL32359_R2_II_SS - 1600 SGD (NI) - DWG 20-30F (2023).pdf</a> Verified By: Jalal Farooq PE # 81223 Created by Independent Third Party: Yes <b>Evaluation Reports</b> <a href="#">FL32359_R2_AE_SS - 1600 SGD (NI) - PAE 2023.pdf</a> Created by Independent Third Party: Yes

[Back](#)

[Next](#)

Contact Us :: [2601 Blair Stone Road, Tallahassee FL 32399](#) Phone: 850-487-1824

The State of Florida is an AA/EEO employer. [Copyright 2007-2013 State of Florida.](#) :: [Privacy Statement](#) :: [Accessibility Statement](#) :: [Refund Statement](#)

Under Florida law, email addresses are public records. If you do not want your e-mail address released in response to a public-records request, do not send electronic mail to this entity. Instead, contact the office by phone or by traditional mail. If you have any questions, please contact 850.487.1395. \*Pursuant to Section 455.275(1), Florida Statutes, effective October 1, 2012, licensees licensed under Chapter 455, F.S. must provide the Department with an email address if they have one. The emails provided may be used for official communication with the licensee. However email addresses are public record. If you do not wish to supply a personal address, please provide the Department with an email address which can be made available to the public. To determine if you are a licensee under Chapter 455, F.S., please click [here](#).



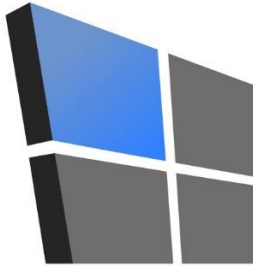

# AL-FAROOQ CORPORATION

CONSULTING ENGINEERS & PRODUCT DEVELOPMENT

January 23, 2023

Product Approval Administrator  
Building Codes & Standards Section  
Department of Business & Professional Regulations  
1940 North Monroe Street, Suite 90  
Tallahassee, FL 32399-2100

To whom it may concern,

As the design engineer retained to prepare the product approval(s) associated with this letter as shown below on this same web page, I do hereby declare that I do not have and will not have any financial interest in any company manufacturing or distributing the referenced product(s), nor do I have or will have any financial interest with any other entity involved in the approval process of the referenced product(s).

Sincerely,



Jalal Farooq, P.E.  
CFO

Sealed: 1/23/2023

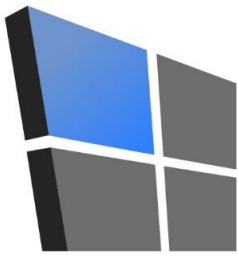

# AL-FAROOQ CORPORATION

CONSULTING ENGINEERS & PRODUCT DEVELOPMENT

## PRODUCT APPROVAL EVALUATION RULE CHAPTER #61G20-3 • METHOD 1 OPTION D

FL 32359

Date: 07/28/2023

**Detailed Product Description:**

**Manufacturer:** SUNSHINE WINDOWS MANUFACTURING, INC.

**Manufacturer Address:** 1785 W 33 PLACE, HIALEAH, FL 33012

**Model Name:** SERIES 1600 ALUMINUM SLIDING GLASS DOOR

**Maximum Load:** +80 PSF, -80 PSF (Large Missile Impact)

**Installation Drawings #** 20-36F

This product complies with the High Velocity Hurricane Zone (HVHZ) testing requirements.

For maximum sizes, combination of span vs loads and anchor type refer to installation drawings.

Comparative analysis used  Yes  No

**Mandatory Tests (Tested in accordance with AAMA 101/I.S.2/NAFS/TAS-202)**

Test	Description	Test Location	Test Report Date	Test Report #	Test Sealed By
ASTM E283	Air Infiltration Leakage	Fenestration Testing Laboratory, Inc.	1/28/2013	FTL-6772	Marlin D. Brinson, PE
ASTM E331 or ASTM 547 & TAS 202	Water Penetration	Fenestration Testing Laboratory, Inc.	1/28/2013	FTL-6772	Marlin D. Brinson, PE
ASTM E330 & TAS 202	Uniform Static Air Pressure	Fenestration Testing Laboratory, Inc.	1/28/2013	FTL-6772	Marlin D. Brinson, PE
ASTM F842	Forced Entry	Fenestration Testing Laboratory, Inc.	1/28/2013	FTL-6772	Marlin D. Brinson, PE

**Supplemental Tests (Tested in accordance with TAS-201 and TAS-203)**

Test	Description	Test Location	Test Report Date	Test Report #	Test Sealed By
FBC 1626.2 TAS 201 & 203	Large Missile Impact & Cyclic	Fenestration Testing Laboratory, Inc.	1/28/2013	FTL-6772	Marlin D. Brinson, PE

Under the limitations of the attached installation drawings, to the best of my knowledge and ability, the above product conforms to the requirements of the 2023 Florida Building Code.

<p><b>Evaluation Report Engineer:</b></p>          <p>Jalal Farooq Al-Farooq Corporation</p>	<div style="text-align: center;"> <p>JALAL FAROOQ LICENSE No. 81223 STATE OF FLORIDA PROFESSIONAL ENGINEER</p> </div> <p style="text-align: right;">Sealed: 7/28/2023</p>
--	---

DESIGN LOAD CAPACITY - PSF													
AVERAGE PANEL WIDTH INCHES	DOOR FRAME HEIGHT INCHES	ANCHORS TYPE 'A'				ANCHORS TYPE 'B'				ANCHORS TYPE 'C'			
		4 ANCHORS AT STILE ENDS		6 ANCHORS AT STILE ENDS		4 ANCHORS AT STILE ENDS		6 ANCHORS AT STILE ENDS		4 ANCHORS AT STILE ENDS		6 ANCHORS AT STILE ENDS	
		EXT.(+)	INT.(-)	EXT.(+)	INT.(-)	EXT.(+)	INT.(-)	EXT.(+)	INT.(-)	EXT.(+)	INT.(-)	EXT.(+)	INT.(-)
30	82	80.0	80.0	80.0	80.0	80.0	80.0	80.0	80.0	80.0	80.0	80.0	80.0
36		80.0	80.0	80.0	80.0	80.0	80.0	80.0	80.0	80.0	80.0	80.0	80.0
42		80.0	80.0	80.0	80.0	80.0	80.0	80.0	80.0	80.0	80.0	80.0	80.0
48		76.0	76.0	80.0	80.0	78.0	78.0	80.0	80.0	80.0	80.0	80.0	80.0
54		71.0	71.0	80.0	80.0	73.0	73.0	80.0	80.0	80.0	80.0	80.0	80.0
30	84	80.0	80.0	80.0	80.0	80.0	80.0	80.0	80.0	80.0	80.0	80.0	80.0
36		80.0	80.0	80.0	80.0	80.0	80.0	80.0	80.0	80.0	80.0	80.0	80.0
42		80.0	80.0	80.0	80.0	80.0	80.0	80.0	80.0	80.0	80.0	80.0	80.0
48		73.0	73.0	80.0	80.0	76.0	76.0	80.0	80.0	80.0	80.0	80.0	80.0
54		68.0	68.0	78.8	78.8	71.0	71.0	78.8	78.8	78.8	78.8	78.8	78.8
30	90	80.0	80.0	80.0	80.0	80.0	80.0	80.0	80.0	80.0	80.0	80.0	80.0
36		80.0	80.0	80.0	80.0	80.0	80.0	80.0	80.0	80.0	80.0	80.0	80.0
42		73.0	73.0	80.0	80.0	75.0	75.0	80.0	80.0	80.0	80.0	80.0	80.0
48		67.0	67.0	78.6	78.6	69.0	69.0	78.6	78.6	77.0	77.0	78.6	78.6
30		96	80.0	80.0	80.0	80.0	80.0	80.0	80.0	80.0	80.0	80.0	80.0
36	75.0		75.0	80.0	80.0	78.0	78.0	80.0	80.0	80.0	80.0	80.0	80.0
42	67.0		67.0	76.5	76.5	69.0	69.0	76.5	76.5	76.5	76.5	76.5	76.5
48	61.0		61.0	73.1	73.1	63.0	63.0	73.1	73.1	71.0	71.0	73.1	73.1

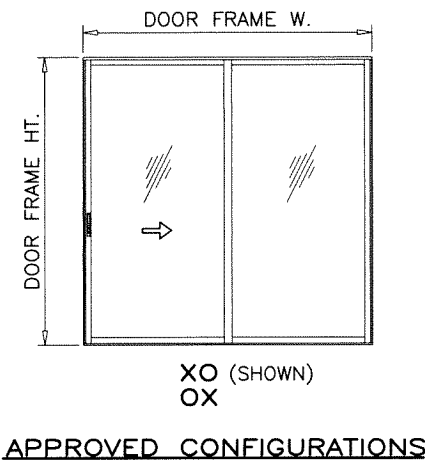

APPROVED CONFIGURATIONS

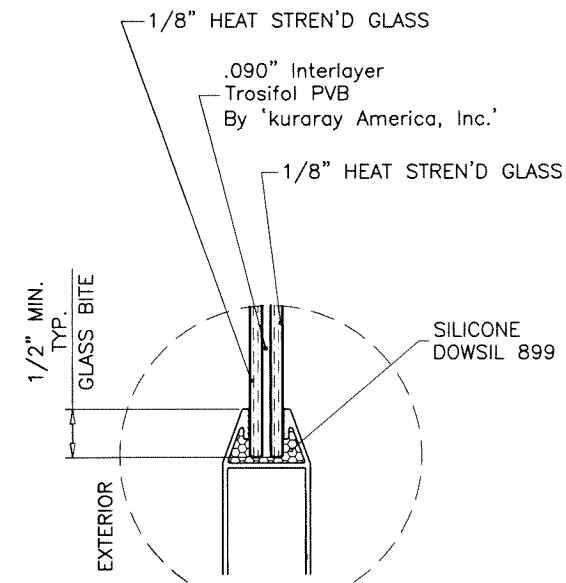

GLAZING DETAIL  
5/16" OVERALL LAM. GLASS

AVERAGE PANEL WIDTH =  $\frac{\text{DOOR FRAME WIDTH}}{\text{NUMBER OF PANELS}}$

DOOR HEIGHT AND WIDTH SIZE MUST COMPLY EGRESS REQUIREMENTS PER FBC AS REQUIRED.

**SERIES-1600  
ALUMINUM SLIDING GLASS DOOR**

DESIGN LOAD RATING FOR THESE DOORS TO BE AS PER CHARTS SHOWN ABOVE.

THIS PRODUCT HAS BEEN DESIGNED AND TESTED TO COMPLY WITH THE REQUIREMENTS OF THE 2020 (7TH EDITION)/2023 (8TH EDITION) FLORIDA BUILDING CODE INCLUDING HIGH VELOCITY HURRICANE ZONE (HVHZ).

1BY OR 2BY WOOD BUCKS & BUCK FASTENERS BY OTHERS, MUST BE DESIGNED AND INSTALLED ADEQUATELY TO TRANSFER APPLIED PRODUCT LOADS TO THE BUILDING STRUCTURE.

ANCHORS SHALL BE CORROSION RESISTANT, SPACED AS SHOWN ON DETAILS AND INSTALLED PER MANUF'S INSTRUCTIONS. SPECIFIED EMBEDMENT TO BASE MATERIAL SHALL BE BEYOND WALL DRESSING OR STUCCO.

A LOAD DURATION INCREASE IS USED IN DESIGN OF ANCHORS INTO WOOD ONLY.

ALL SHIMS TO BE HIGH IMPACT, NON-METALLIC AND NON-COMPRESSIBLE.

MATERIALS INCLUDING BUT NOT LIMITED TO STEEL/METAL SCREWS, THAT COME INTO CONTACT WITH OTHER DISSIMILAR MATERIALS SHALL MEET THE REQUIREMENTS OF THE 2020/2023 FLORIDA BLDG. CODE & ADOPTED STANDARDS.

THIS PRODUCT APPROVAL IS GENERIC AND DOES NOT PROVIDE INFORMATION FOR A SITE SPECIFIC PROJECT, i.e. LIFE SAFETY OF THIS PRODUCT, ADEQUACY OF STRUCTURE RECEIVING THIS PRODUCT AND SEALING AROUND OPENING FOR WATER INFILTRATION RESISTANCE ETC.

CONDITIONS NOT SHOWN IN THIS DRAWING ARE TO BE ANALYZED SEPARATELY, AND TO BE REVIEWED BY BUILDING OFFICIAL.

DESIGN LOADS SHOWN ARE BASED ON 'ALLOWABLE STRESS DESIGN (ASD)'.

MANUFACTURER'S LABEL SHALL BE LOCATED ON A READILY VISIBLE LOCATION IN ACCORDANCE WITH SECTION 1709.9.3 OF FLORIDA BUILDING CODE. LABELING TO COMPLY WITH SECTION 1709.9.2.

NOTE:  
GLASS CAPACITIES ON THIS SHEET ARE BASED ON ASTM E1300-09 (3 SEC. GUSTS) AND FLORIDA BUILDING COMMISSION DECLARATORY STATEMENT DCA05-DEC-219

THESE DOORS ARE RATED FOR LARGE & SMALL MISSILE IMPACT. SHUTTERS ARE NOT REQUIRED.

LAMINATED GLASS  
LARGE MISSILE IMPACT

Sealed: 7/26/2023

FL #32359

- A- CONTRACTOR TO BE RESPONSIBLE FOR THE SELECTION, PURCHASE AND INSTALLATION OF THIS PRODUCT BASED ON THIS PRODUCT EVALUATION PROVIDED HE/SHE DOES NOT DEVIATE FROM THE CONDITIONS DETAILED ON THIS DOCUMENT.
- B- THIS PRODUCT EVALUATION DOCUMENT WILL BE CONSIDERED INVALID IF ALTERED BY ANY MEANS.
- C- SITE SPECIFIC PROJECTS SHALL BE PREPARED BY A FLORIDA REGISTERED ENGINEER OR ARCHITECT WHICH WILL BECOME THE ENGINEER OF RECORD (E.O.R.) FOR THE PROJECT AND WHO WILL BE RESPONSIBLE FOR THE PROPER USE OF THE P.E.D. ENGINEER OF RECORD, ACTING AS A DELEGATED ENGINEER TO THE P.E.D. ENGINEER SHALL SUBMIT TO THIS LATTER THE SITE SPECIFIC DRAWINGS FOR REVIEW.
- D- THIS P.E.D. SHALL BEAR THE DATE AND ORIGINAL SEAL AND SIGNATURE OF THE PROFESSIONAL ENGINEER OF RECORD THAT PREPARED IT.

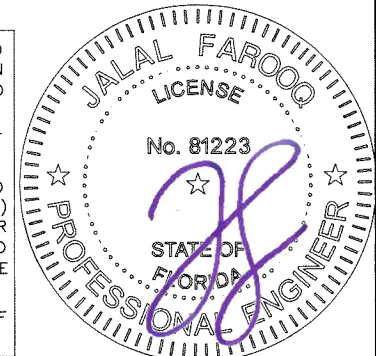

SERIES-1600 ALUM SLIDING GLASS DOOR (L.M.I.)  
**Sunshine Windows Manufacturing, Inc.**  
1785 West 33rd Place  
Hialeah, FL 33012  
Tel. (305) 364-9952 Fax. (305) 828-5118

**a f c**  
**AL-FAROOQ CORPORATION**  
ENGINEERS & PRODUCT DEVELOPMENT  
9360 SUNSET DRIVE, SUITE 220  
MIAMI, FLORIDA 33173 (C.A.N. 3538)  
TEL. (305) 264-8100 FAX. (305) 262-6978  
COMP-ANL 20-36F-SWM

revisions:	no	date	description
	A	08.27.20	UPDATED TO 2020 FBC
	B	07.21.23	UPDATED TO 2023 FBC
date:	04-01-20		
scale:	1/2" = 1"		
dr. by:	TARIQ		
chk. by:			
drawing no.	20-36F		
sheet	1 of 8		

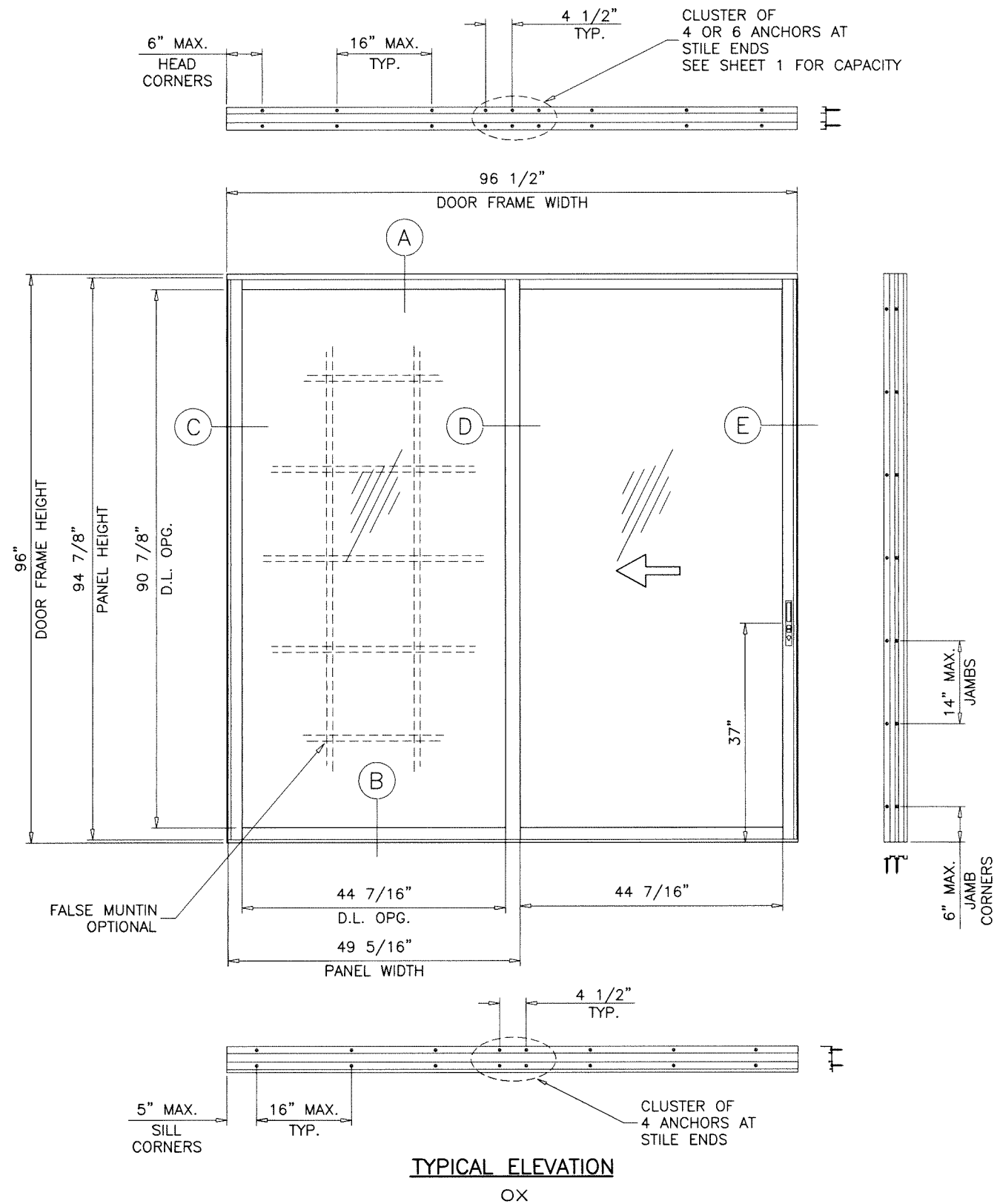

DAYLITE OPENINGS WIDTHS:  
 PANEL WIDTH - 7.125"  
 DAYLITE OPENING HEIGHT:  
 PANEL HEIGHT - 6.50"  
 PANEL HEIGHT = DOOR FRAME HEIGHT - 1.5625"

Sealed: 7/26/2023

FL #32359

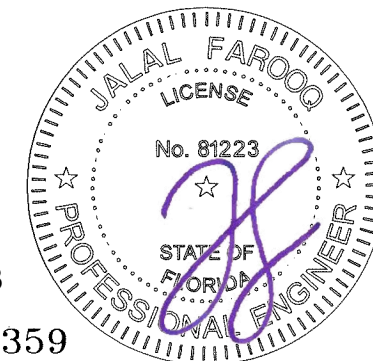

**af c**

**AL-FAROOQ CORPORATION**  
 ENGINEERS & PRODUCT DEVELOPMENT  
 9360 SUNSET DRIVE, SUITE 220 (C.A.N. 3538)  
 MIAMI, FLORIDA 33173 TEL. (305) 264-8100 FAX. (305) 262-6978  
 COMP-ANL\20-36F-SWM

SERIES-1600 ALUM SLIDING GLASS DOOR (L.M.I.)

**Sunshine Windows Manufacturing, Inc.**  
 1785 West 33rd Place  
 Hialeah, FL. 33012  
 Tel. (305) 364-9952 Fax. (305) 828-5118

revisions:	no	date	description

date: 04-01-20  
 scale: 1/2" = 1'-0"  
 dr. by: TARIQ  
 chk. by:

drawing no.  
**20-36F**

sheet 2 of 8

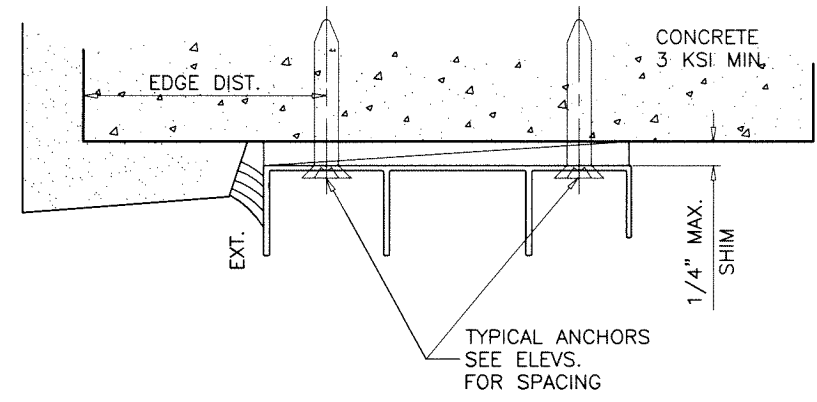
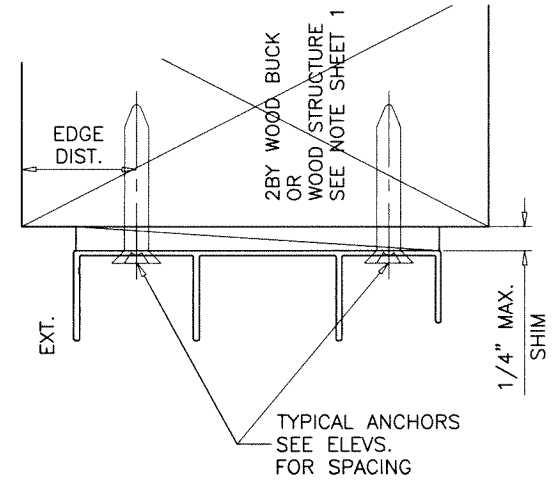
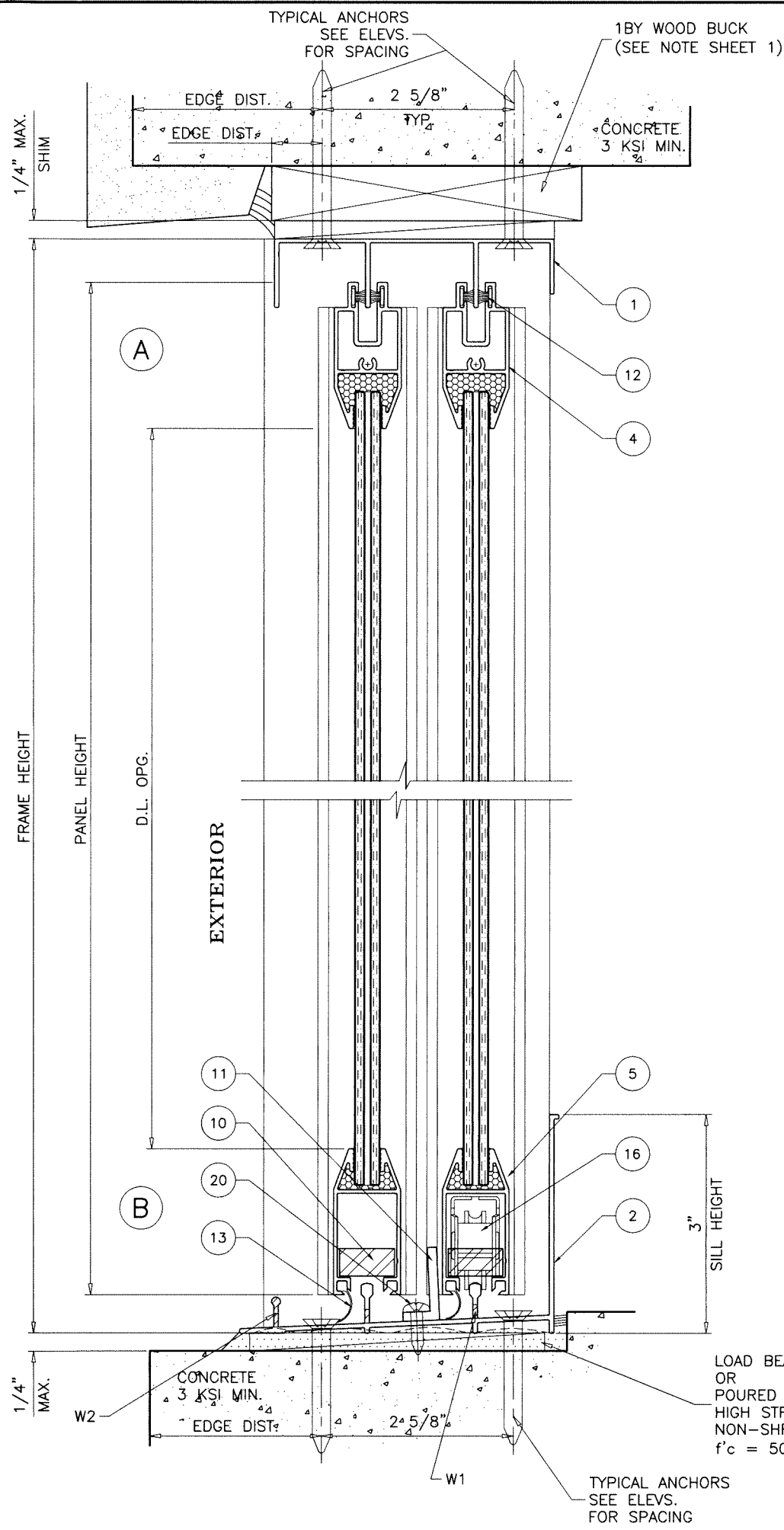

**WEEPHOLES:**

- W1 = 3/16" X 1" LONG WEEP HOLES AT EACH END OF TRACK
- W2 = 2" LONG NOTCH AT EACH END OF TRACK

LOAD BEARING SHIMS OR  
POURED & HARDENED  
HIGH STRENGTH GROUT  
NON-SHRINK, NON-METALLIC  
f'c = 5000 PSI MIN.



Sealed: 7/26/2023

FL #32359

**afc**

**AL-FAROOQ CORPORATION**  
ENGINEERS & PRODUCT DEVELOPMENT  
9360 SUNSET DRIVE, SUITE 220  
MIAMI, FLORIDA 33173 (C.A.N. 3538)  
TEL. (305) 264-8100 FAX. (305) 262-6978  
COMP-ANL\20-36F-SWM

---

SERIES-1600 ALUM SLIDING GLASS DOOR (L.M.I.)  
**Sunshine Windows Manufacturing, Inc.**  
1785 West 33rd Place  
Hialeah, FL. 33012  
Tel. (305) 364-9952 Fax. (305) 828-5118

no	date	description

date: 04-01-20  
scale: 1/2" = 1"  
dr. by: TARIQ  
chk. by:      

drawing no.  
**20-36F**

sheet 3 of 8

1BY OR 2BY WOOD BUCKS AND METAL STRUCTURE NOT BY 'SUNSHINE WDW,' MUST SUSTAIN LOADS IMPOSED BY GLAZING SYSTEM AND TRANSFER THEM TO THE BUILDING STRUCTURE.

**TYPICAL ANCHORS:** SEE ELEV. FOR SPACING  
**AT HEAD**

**TYPE 'A'—** 1/4" DIA. ULTRACON+ BY 'DEWALT' (Fu=164 KSI, Fy=148 KSI)  
 INTO 2BY WOOD BUCKS OR WOOD STRUCTURES  
 1-1/2" MIN. PENETRATION INTO WOOD  
 THRU 1BY BUCKS INTO CONCRETE  
 1-1/4" MIN. EMBED INTO CONCRETE

**TYPE 'B'—** 1/4" DIA. ULTRACON+ BY 'DEWALT' (Fu=164 KSI, Fy=148 KSI)  
 DIRECTLY INTO CONCRETE  
 1-1/4" MIN. EMBED INTO CONCRETE

**TYPE 'C'—** 1/4" DIA. TEKS OR SELF-DRILLING SCREWS (GRADE 5 CRS)  
 INTO F.B.C. APPROVED MULLIONS  
 AND  
 INTO METAL STRUCTURES  
 (3) THREADS MIN. TO EXTEND BEYOND METAL THICKNESS  
 ALUMINUM: 1/8" THK. MIN. (6063-T5 MIN.)  
 STEEL: 1/8" THK. MIN. (Fy = 36 KSI MIN.)  
 (STEEL IN CONTACT WITH ALUMINUM TO BE PLATED OR PAINTED)

**AT SILL**

**TYPE 'B'—** 1/4" DIA. ULTRACON+ BY 'DEWALT' (Fu=164 KSI, Fy=148 KSI)  
 DIRECTLY INTO CONCRETE  
 1-1/4" MIN. EMBED INTO CONCRETE

**AT JAMBS**

**TYPE 'A'—** 1/4" DIA. ULTRACON+ BY 'DEWALT' (Fu=164 KSI, Fy=148 KSI)  
 INTO 2BY WOOD BUCKS OR WOOD STRUCTURES  
 1-1/2" MIN. PENETRATION INTO WOOD  
 THRU 1BY BUCKS INTO CONC. OR BLOCKS  
 1-1/4" MIN. EMBED INTO CONCRETE OR BLOCKS

**TYPE 'B'—** 1/4" DIA. ULTRACON+ BY 'DEWALT' (Fu=164 KSI, Fy=148 KSI)  
 DIRECTLY INTO CONCRETE OR BLOCKS  
 1-1/4" MIN. EMBED INTO CONCRETE OR BLOCKS

**TYPE 'C'—** 1/4" DIA. TEKS OR SELF-DRILLING SCREWS (GRADE 5 CRS)  
 INTO F.B.C. APPROVED MULLIONS  
 AND  
 INTO METAL STRUCTURES  
 (3) THREADS MIN. TO EXTEND BEYOND METAL THICKNESS  
 ALUMINUM: 1/8" THK. MIN. (6063-T5 MIN.)  
 STEEL: 1/8" THK. MIN. (Fy = 36 KSI MIN.)  
 (STEEL IN CONTACT WITH ALUMINUM TO BE PLATED OR PAINTED)

**CRITICAL EDGE DISTANCE**

INTO CONCRETE AND BLOCKS = 2-1/2" MIN.  
 INTO WOOD STRUCTURE = 1" MIN.  
 INTO METAL STRUCTURE = 3/4" MIN.

WOOD AT HEAD, SILL OR JAMBS SG = 0.55 MIN.  
 CONCRETE AT HEAD, SILL OR JAMBS f'c = 3000 PSI MIN.  
 C-90 HOLLOW/FILLED BLOCK AT JAMBS f'm = 2000 PSI MIN.

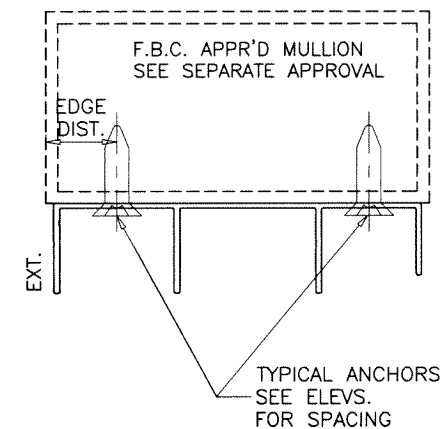
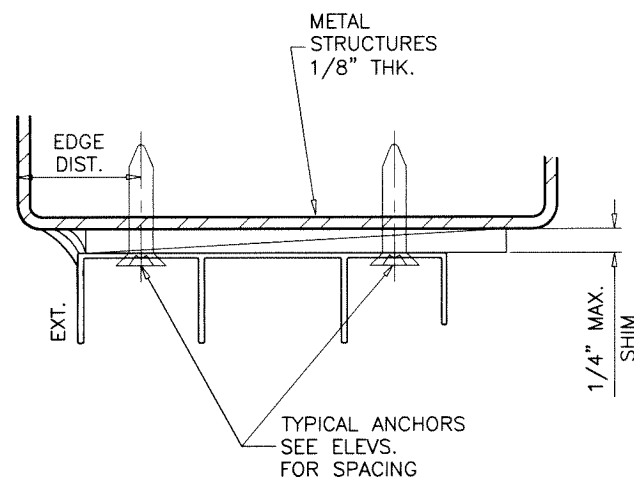

Sealed: 7/26/2023

FL #32359

**a f c**

**AL-FAROOQ CORPORATION**  
 ENGINEERS & PRODUCT DEVELOPMENT  
 9360 SUNSET DRIVE, SUITE 220  
 MIAMI, FLORIDA 33173 (C.A.N. 3538)  
 TEL. (305) 264-8100 FAX. (305) 262-6978

SERIES-1600 ALUM SLIDING GLASS DOOR (L.M.I.)

**Sunshine Windows Manufacturing, Inc.**

1785 West 33rd Place  
 Hialeah, FL 33012

Tel. (305) 364-9952 Fax. (305) 828-5118

revisions:  
 no. date by description

date: 04-01-20  
 scale: 1/2" = 1"  
 dr. by: TARIQ  
 chk. by:

drawing no.  
**20-36F**

sheet 4 of 8

COMP-ANL\20-36F-SWM

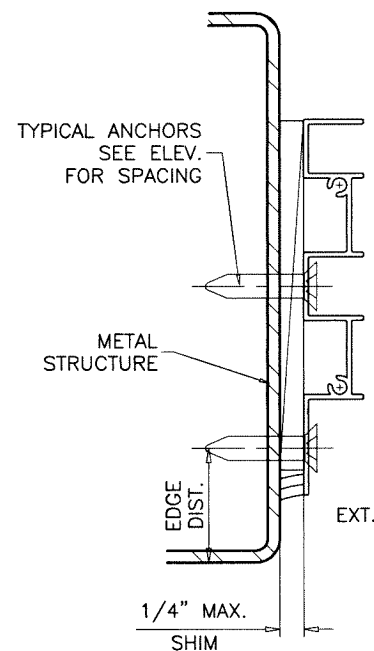
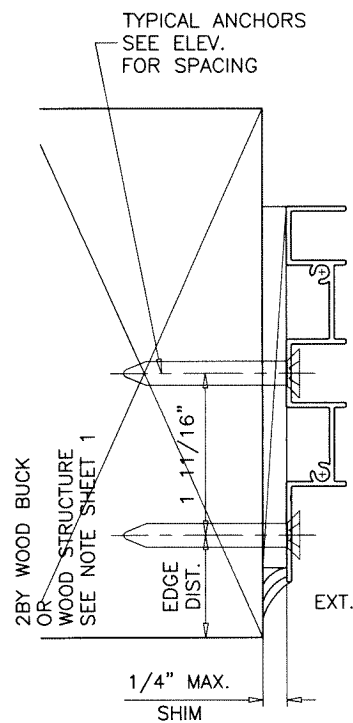
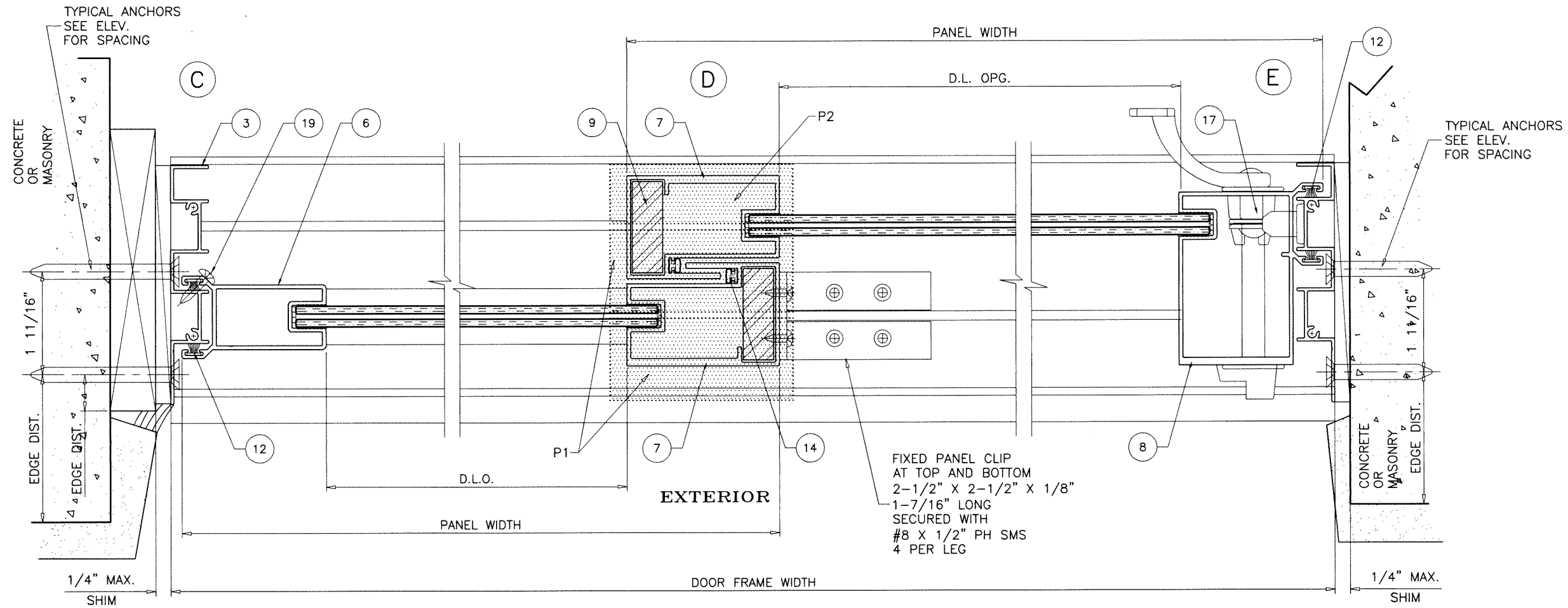

**PILE PADS:**

- P1 = SELF ADHESIVE PILE PAD AT TOP AND BOTTOM  
1-3/8" X 3" LONG
- P2 = SELF ADHESIVE PILE PAD AT TOP AND BOTTOM  
1" X 3" LONG

Sealed: 7/26/2023

FL #32359

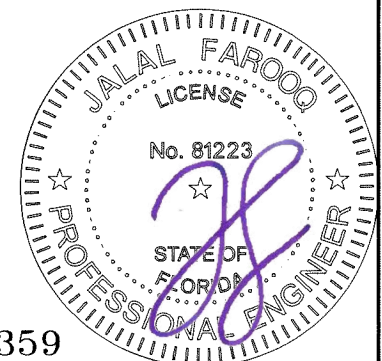

**af c**  
**AL-FAROOQ CORPORATION**  
 ENGINEERS & PRODUCT DEVELOPMENT  
 9360 SUNSET DRIVE, SUITE 220 (C.A.N. 3538)  
 MIAMI, FLORIDA 33173  
 TEL. (305) 264-8100 FAX. (305) 262-6978  
 COMP-ANL \ 20-36F-SWM

SERIES-1600 ALUM SLIDING GLASS DOOR (L.M.I.)  
**Sunshine Windows Manufacturing, Inc.**  
 1785 West 33rd Place  
 Hialeah, FL. 33012  
 Tel. (305) 364-9952 Fax. (305) 828-5118

revisions:	no	date	by	description
date:	04-01-20	scale:	1/2" = 1"	
dr. by:	TARIQ	chk. by:		
drawing no.	20-36F			
sheet	5 of 8			

ITEM #	PART #	QUANTITY	DESCRIPTION	MATERIAL	MANF./SUPPLIER/REMARKS
1	SW-002	1	FRAME HEAD	6063-T6	-
2	SSW-0002	1	HI-RISE FRAME SILL	6063-T6	-
3	SW-001	2	FRAME JAMB	6063-T6	-
4	SW-005	1/ PANEL	PANEL TOP RAIL	6063-T6	-
5	SW-004	1/ PANEL	PANEL BOTTOM RAIL	6063-T6	-
6	SW-006	2/ PANEL	PANEL FIXED STILE	6063-T6	-
7	SW-999	AS REQD.	PANEL INTERLOCK STILE	6063-T6	-
8	BA-4828	AS REQD.	PANEL H.D. LOCK STILE	6063-T6	-
9	-	AS REQD.	INTERLOCK REINF. BAR	STEEL	A36, Fu MIN. = 58 KSI
10	-	2	BOTTOM RAIL REINF. BAR	STEEL	A36, Fu MIN. = 58 KSI
11	-	1	RETAINER CLIP, 4-1/8" LONG	6063-T6	AT MID WIDTH OF MOV. PANEL
12	W11255NK000B	AS REQD.	PILE W'STRIPPING	POLYPROPYLENE	ULTRAFAB, #250
13	MPI N/P 4009	AS REQD.	FLAP W'STRIPPING	VINYL	MELTPPOINT PLASTICS
14	MPI N/P 3252A	AS REQD.	BULB W'STRIPPING	VINYL	MELTPPOINT PLASTICS
16	PJS-03-BSS	2/ MOV. PANEL	TANDEM STEEL WHEELS IN METALLIC HOUSING	ST. STEEL	SULLIVAN & ASSOC.
17	SM4400-SUN	AS REQD.	FLUSH MOUNT HOOK LOCK	ZINC/ST. STEEL	SULLIVAN & ASSOC.
18	#8 X 1"	AS REQD.	FRAME/PANEL ASSEMBLY FASTENERS	ST. STEEL	PH SMS
19	#8 X 1"	AS REQD.	FIX. PANEL FASTENERS, AT 6" FROM ENDS & 17" O.C. MAX.	ST. STEEL	PH SMS
20	#10 X 1"	3/ CLIP	RETAINER CLIP FASTENERS	ST. STEEL	PH SMS

**LOCK:**

SURFACE MOUNT METALLIC HANDLE AT 37" FROM BOTTOM  
FASTENED TO LOCK STILE WITH  
(2) #10-24 X 2-3/4" OH MS

SURFACE MOUNT METALLIC 3 PLY HOOK LOCK AT  
37" FROM BOTTOM  
FASTENED TO LOCK STILE WITH  
(2) #10-32 X 1/2" FH MS

SURFACE MOUNT METALLIC KEEPER AT 35-1/2" FROM BOTTOM  
FASTENED TO FRAME JAMB AND ASTRAGAL STILE WITH  
(2) #10 X 5/8" PH SMS

**SEALANT:**

ALL JOINTS AND FRAME CONNECTIONS SEALED WITH  
WHITE/ALUMINUM COLORED SILICONE.

**afc**

**AL-FAROOQ CORPORATION**  
ENGINEERS & PRODUCT DEVELOPMENT  
9360 SUNSET DRIVE, SUITE 220  
MIAMI, FLORIDA 33173 (C.A.N. 3538)  
TEL. (305) 264-8100 FAX. (305) 262-6978

COMP-ANL \ 20-36F-SWM

SERIES-1600 ALUM SLIDING GLASS DOOR (L.M.I.)

**Sunshine Windows Manufacturing, Inc.**

1785 West 33rd Place  
Hialeah, FL 33012

Tel. (305) 364-9952 Fax. (305) 828-5118

revisions:  
no date by description

date: 04-01-20

scale: 1/2" = 1"

dr. by: TARIO

chk. by:

drawing no.

**20-36F**

sheet 6 of 8

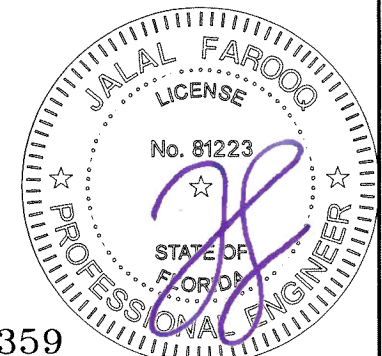

Sealed: 7/26/2023

FL #32359

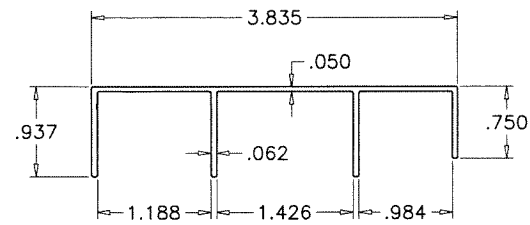

1 FRAME HEAD

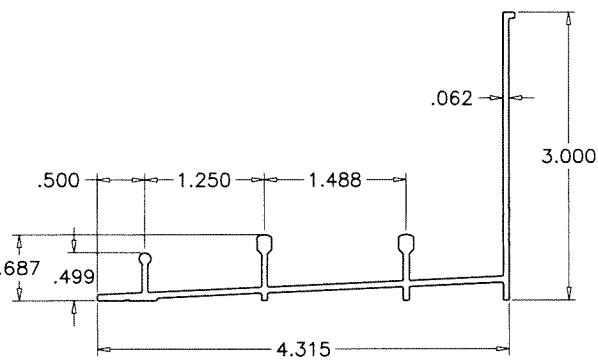

2 FRAME SILL

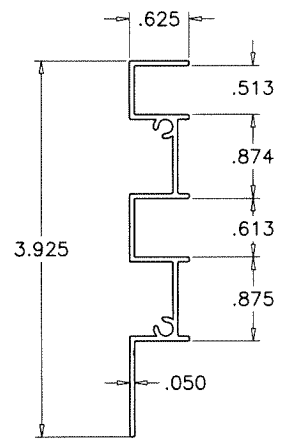

3 FRAME JAMB

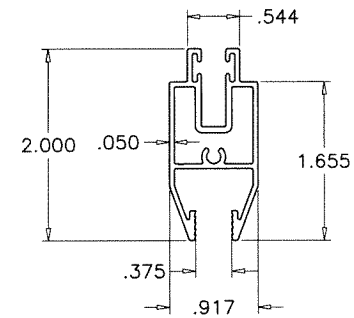

4 PANEL TOP RAIL

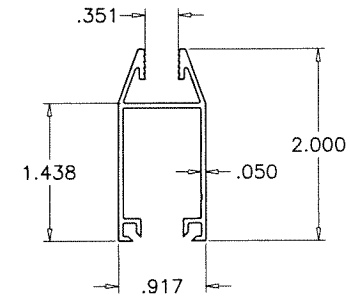

5 PANEL BOTTOM RAIL

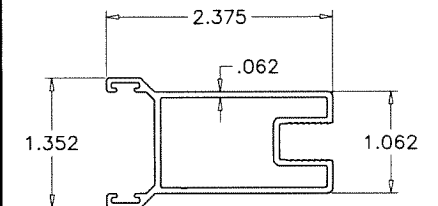

6 PANEL FIX. STILE

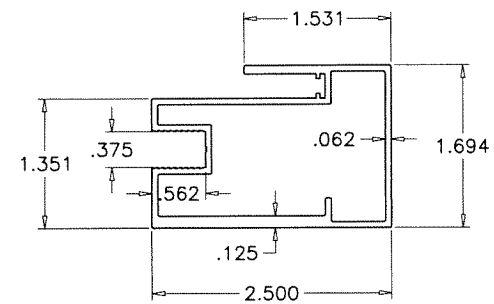

7 PANEL INTERLOCK

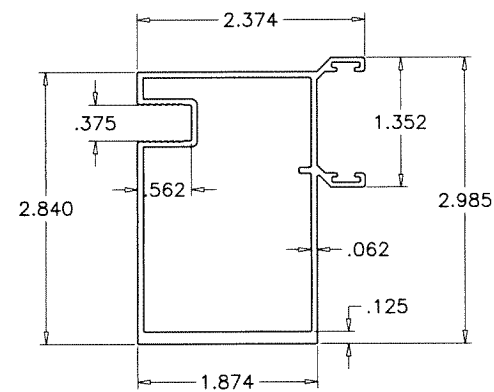

8 PANEL H.D. LOCK STILE

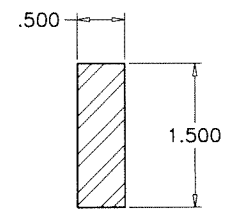

9 INTERLOCK REINF.

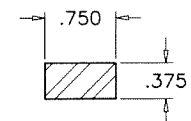

10 BOTTOM RAIL REINF.

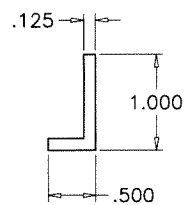

11 RETAINER CLIP

**af c**  
**AL-FAROOQ CORPORATION**  
 ENGINEERS & PRODUCT DEVELOPMENT  
 9360 SUNSET DRIVE, SUITE 220 (C.A.N. 3538)  
 MIAMI, FLORIDA 33173 TEL. (305) 262-6978  
 TEL. (305) 264-8100 FAX. (305) 264-8100  
 COMP-ANL \20-36F-SWM

SERIES-1600 ALUM SLIDING GLASS DOOR (L.M.I.)  
**Sunshine Windows Manufacturing, Inc.**  
 1785 West 33rd Place  
 Hialeah, FL. 33012  
 Tel. (305) 364-9952 Fax. (305) 828-5118

no	date	by	description

date: 04-01-20  
 scale: 1/2" = 1"  
 dr. by: TARIQ  
 chk. by:

drawing no.  
**20-36F**  
 sheet 7 of 8

Sealed: 7/26/2023

FL #32359



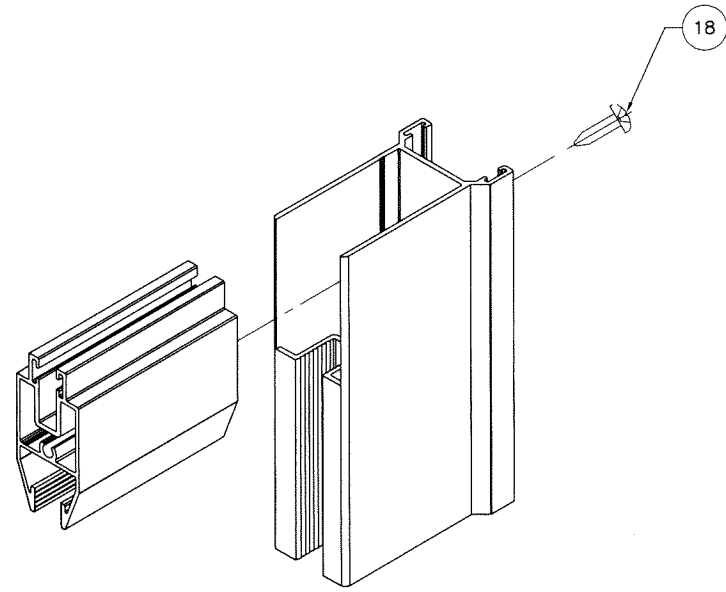

PANEL TOP CORNER

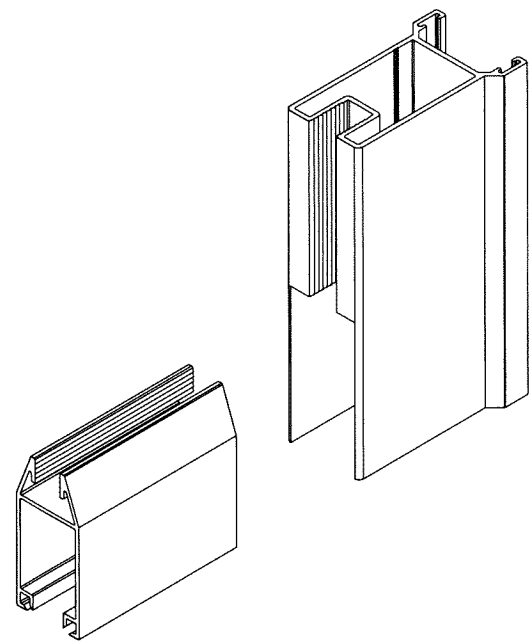

PANEL BOTTOM CORNER

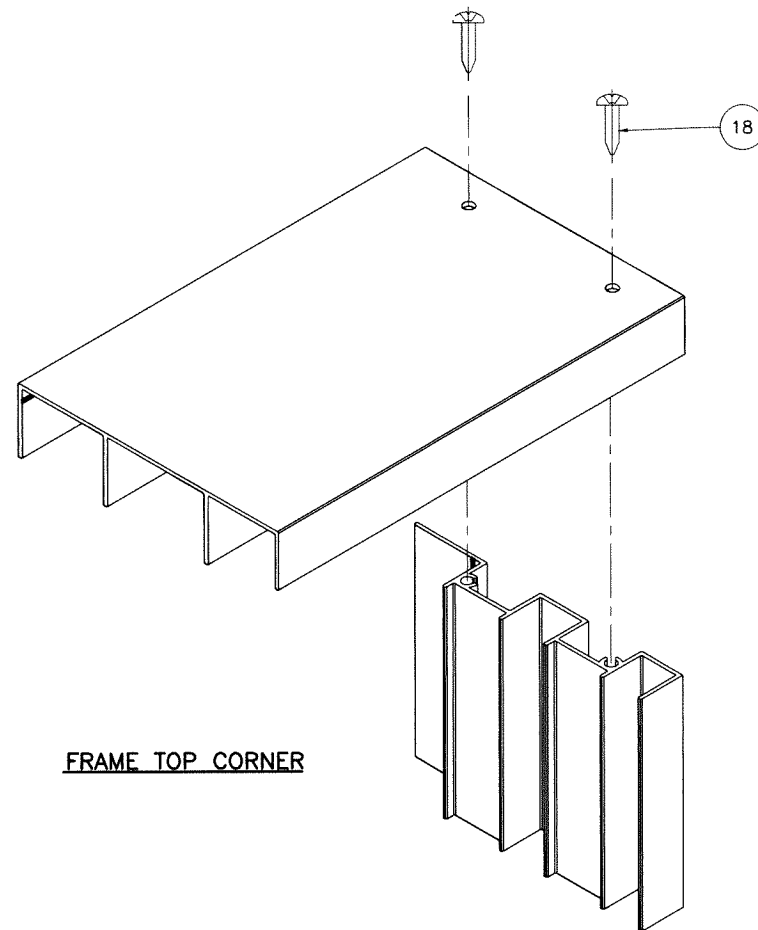

FRAME TOP CORNER

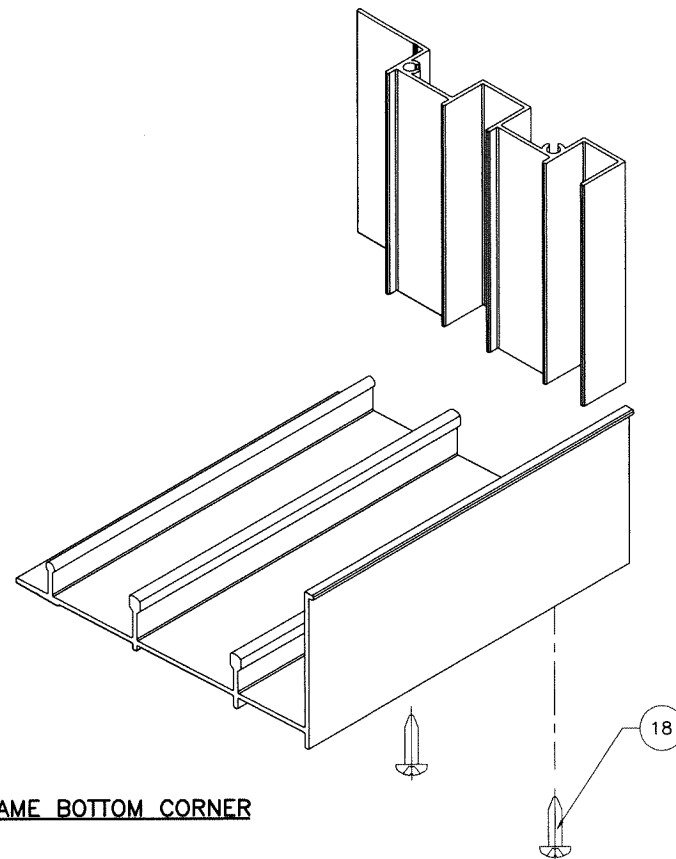

FRAME BOTTOM CORNER

Sealed: 7/26/2023

FL #32359



**afc**  
**AL-FAROOQ CORPORATION**  
 ENGINEERS & PRODUCT DEVELOPMENT  
 9360 SUNSET DRIVE, SUITE 220 (C.A.N. 3538)  
 MIAMI, FLORIDA 33173 TEL. (305) 262-6978  
 FAX. (305) 264-8100

SERIES-1600 ALUM SLIDING GLASS DOOR (L.M.I.)  
**Sunshine Windows Manufacturing, Inc.**  
 1785 West 33rd Place  
 Hialeah, FL. 33012  
 Tel. (305) 364-9952 Fax. (305) 828-5118

revisions:	no	date	by	description

date: 04-01-20  
 scale: 1/2" = 1"  
 dr. by: TARIQ  
 chk. by:

drawing no.  
**20-36F**

sheet **8** of **8**

COMP-ANL\20-36F-SWM